

XTRAVELLER HYBRID

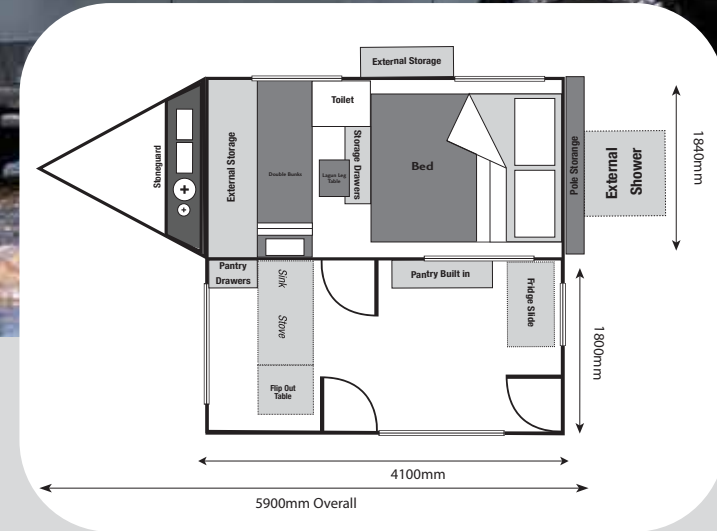
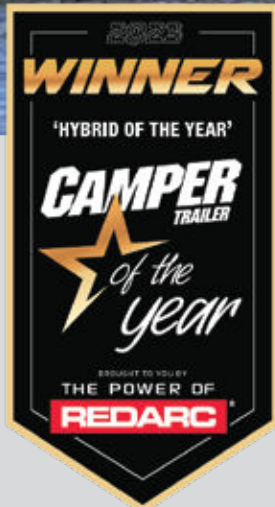

1300 594 000

BLUEWATERCAMPERS.COM.AU

ONLY
\$46,990*

*Registrations, Dealer and Delivery charges may apply

XTRAVELLER

HYBRID CAMPER TRAILER

ONLY
\$46,990*

*Registrations , Dealer and Delivery charges may apply

GENERAL SPECIFICATIONS

Tare - 1870kg including standard features

ATM - 2500kg

Payload - 630kg

Ball Weight - 210kg

Dimensions - (L) 5.9m x (W) 1.9m x (H) 2.1m

TENT SPECIFICATIONS

Enclosed Annex with Roof, Walls, Wind Flaps, Floor, verandahs & Poles included

Heavy Duty 'Close Weave' 440g/m2 (15.5oz)

Self repairing zippers to all windows & doors

Awnlux Roof Mounted pull out style awning with anti flap kit

Drop down Bagged Shower Ensuite, swings out on Gas Struts

Windows Tinted Inside Flyscreen and Blockout Blinds

SLEEPING

Sleeping Accommodation for 4

Queen Size Pocket Spring Mattress & high density foam in bunks

Bunk Bed - 1700x650mm

Reading lights either side of bed with 12v socket & USB Connection

ELECTRICAL

Multiple 12v & USB sockets, inside and out

240V fully installed by local certified electrician with 15A inlet

Anderson plug connectors for vehicle and solar input for extra panel

2 x 135ah BSL Lithium Batteries with in built BMS

Redarc Battery Management System BMS1230R with Redvision Display

Redarc 350W Pure Sine Wave Inverter (option to upgrade to 2000W)

12V & Fresh and Grey Water Level Indicator Gauges

2 x 200W Roof Mounted Solar Panels

Electric Emergency Breakway with 2 ADR Compliant Safety Chains

Truma Ultra Rapid Hot Water 14l storage unit, gas & 240v

Premium MP5 Stereo Unit 7" Screen with integrated 4 Speaker Entertainment System & Bluetooth Function

Internal and External LED Lights with Orange Bug Repellent option

STORAGE

Multiple storage Compartments inside & out - including huge under bed storage

Fridge Slide: 1000 long x 580 high x 540 wide

Provision for Rear bike rack tongue / receiver

Rear Pole Box Storage fitted

2 x gas bottle holders & Jerry Can tie downs

TRAILER SPECIFICATIONS

Fully Welded Aluminium Body, Underbody Sealer, Proof Coated with Mud Flaps

Drawbar Full Length RHS Galvanised 120x50x4mm

RHS Galvanised Chassis 75x50x4mm Proof Coated

Cruisemaster D035 Hitch 3.5T and trailer plug included to suit your tow vehicle

12" Electric Drums with Mechanical Handbrake and Electric breakaway

ARK XO 750kg rated Off Road Dual Wheel Jockey Wheel

4 'drop down' adjustable stabiliser legs

Adjustable Independent Suspension Heavy Duty Coil Springs with Twin RidePro Shock Absorbers

Dual rear rated Heavy Duty recovery shackles

265/75 R16 MT or AT Tyres on Alloy Rims, Rear mounted spare Tyre with Toolbox (second spare optional)

200ltr Total Water Tank capacity (F-80ltr & R-120ltr) + 60ltr Grey Water Tank

Theford 3 Burner Stove, sink, dish drainer, 12v Light, bench Extension & Australian LPG Compliance

External Hand Shower to outside Ensuite with hot/Cold operation

Seafo Water Pump with John Guest Hose and Fittings

Mains water connection with Pressure Reducing Valve

Positive Pressure Dust Reduction Fan Fitted

ALL PRODUCT INFORMATION, SPECS AND PRICING CORRECT AT TIME OF PRINTING AND MAY BE CHANGED BY THE MANUFACTURER WITHOUT NOTICE. PLEASE CHECK WITH YOUR CUSTOMER SERVICE REPRESENTATIVE FOR ANY UPDATES. - ABN: 94 005 451 007



VISIT OUR WEBSITE FOR UPGRADES LIST AND PHOTO GALLERY

BLUEWATERCAMPERS.COM.AU

1300 594 000



VISIT US AT ONE OF OUR SHOWROOMS

VICTORIA
31 Commercial Drive
Pakenham, VIC 3810
T: (03) 5945 5300

NEW SOUTH WALES (MD072927)
39-41 Shelley Road
Moruya, NSW 2537
T: (02) 4474 4410

QUEENSLAND
9 Indy Court
Carrara, QLD 4211
T: (07) 3333 1952

SOUTH AUSTRALIA (MD29134)
46 Stebbing Road
Maddington, WA 6109
T: (08) 8522 1141

SOUTH AUSTRALIA (AGENT) ALBURY/WODONGA (AGENT)
Barossa Off-Road
3/27 Theen Ave
Willaston, SA 5118
T: (08) 8522 1141

Albury/Wodonga 4x4
1/4 Kane Road
Wodonga, VIC 3690
T: (02) 6056 1138



EAGLE PART OF THE OUTDOORS GROUP